

Stainless Steel Pipe Fittings and Ball Valves

Web: www.kxcasting.com

Email: linda@quickcoupling.net.cn

Office: 14F-1417, No.49 Zhaiying St, Yuhua District, Shijiazhuang, 050000

Factory: No.17 East industrial Park, Anping county, Hebei, 053600, China



We, a manufacturing and trading combo, produce and export pipe fittings and ball valves since 2002, especially focus on stainless steel pipe fittings and stainless steel ball valves.

We are the family owned team, Mr. Yan brothers established KX Co. (Anping county KaiXuan stainless steel products Co., Ltd) and built the plant in 2002. Mr. Yan brothers' younger generation heads KX Co.'s global business development, strategy, and marketing.

Every worker try their best to do the best pipe fittings and valves to serve and feedback to customers, all of us want to take this job constantly continue, we are the most stable fittings and valves supplier and reliable team of yours.

Delivering premium quality products at competitive prices. But, it's not the single reason why customers opt for KX Co. Selling a product is one thing; prompt and correct delivery is another. At KX Co., fast, reliable delivery and service quality are held in the highest regard. We are on a never-ending quest to develop new products for more customers.

We take on the future: optimal service & prompt, accurate delivery, just as our customers have come to expect from us: "Superior in price and quality!"

A good product speaks for itself that it's always the idea that values.



Stainless Steel PEX Fittings

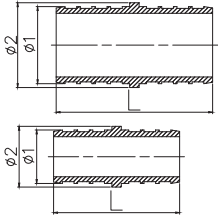

PEX COUPLING

Size	1/2P*1/2P	3/4P*3/4P	1P*1P
$\phi 1(\text{mm})$	12.0	17.0	21.8
$\phi 2(\text{mm})$	14.0	19.0	24.0
L(mm)	35.0	35.0	44.0

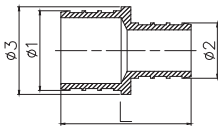

PEX REDUCING COUPLING

Size	3/4P*1/2P	1P*3/4P
$\phi 1(\text{mm})$	17.0	21.8
$\phi 2(\text{mm})$	12.0	17.0
$\phi 3(\text{mm})$	19.0	24.0
L(mm)	35.6	40.0

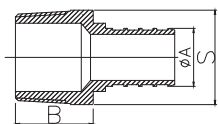

PEX MALE ADAPTER

Size	1/2P*3/4M	1/2P*1/2M	3/4P*1/2M	3/4P*3/4M	1P*3/4M	1P*1M
$\phi A(\text{mm})$	12.0	12.0	17.0	17.0	21.7	21.7
B(mm)	42.5	42.4	42.5	42.4	47.0	48.0
S(mm)	27.0	22.0	22.0	27.0	27.0	35.0



Stainless Steel PEX Fittings

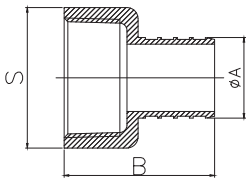

PEX FEMALE ADAPTER

Size	1/2P*3/4F	1/2P*1/2F	3/4P*1/2F	3/4P*3/4F	1P*1F
φA(mm)	12.0	12.0	17.0	17.0	21.8
B(mm)	34.5	34.5	34.0	34.5	40.7
S(mm)	31.0	25.0	25.0	31.0	38.0

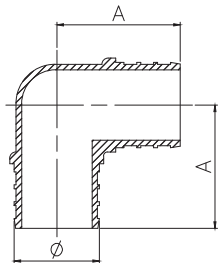

PEX ELBOW

Size	1/2P*1/2P	3/4P*3/4P	1P*1P
A(mm)	24.2	26.5	35.0
φ(mm)	12.0	17.0	21.8

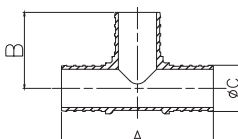

PEX TEE

Size	1/2P*1/2P*1/2P	3/4P*3/4P*3/4P	1P*1P*1P
A(mm)	48.3	53.0	70.0
B(mm)	24.15	26.5	35.0
φC(mm)	12.0	17.0	21.8

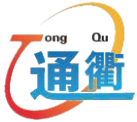

Stainless Steel PEX Fittings

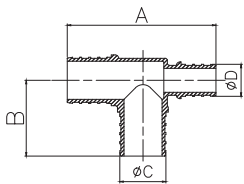

PEX REDUCING TEE

Size	3/4P*1/2P*1/2P	3/4P*1/2P*3/4P	1P*3/4P*3/4P	1P*1/2P*1P	1P*3/4P*1P
A(mm)	53.3	53.6	67.0	67.0	67.0
B(mm)	26.3	27.0	32.0	35.0	35.0
ϕC (mm)	17.0	17.0	21.8	21.8	21.8
ϕD (mm)	12.0	12.0	17.0	12.0	17.0

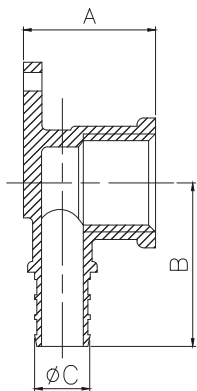

PEX DROP EAR ELBOW

Size	1/2P*1/2F	3/4P*3/4F
A(mm)	28.5	31.9
B(mm)	35.2	37.2
ϕC (mm)	12.0	17.0

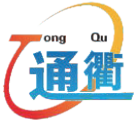

Stainless Steel PEX Ball Valve

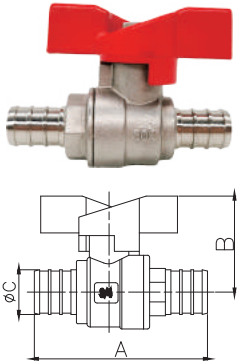

PEX BALL VALVE

Size	1/2P*1/2P	3/4P*3/4P	1P*1P
A(mm)	62.5	65.8	77.1
B(mm)	33.3	36.0	40.0
φC(mm)	12.0	17.0	21.8

Stainless Steel PEX Ball Valves

Material: Stainless Steel 304, 316, 1.4308, 1.4408, CF8, CF8M

End Connection: PEX/Crimp

PEX Valve Type: Crimp

PEX Tubing Compatibility: PEX types A, B, C

Medium: Water, Oil, Gas, Corrosive liquid

Process: Precision Investment Casting

Casting Conforms to ASTM A351, etc.

Pressure: 400 PSI

Size: 1/2" 3/4" 1"

Stainless Steel PEX ball valves are full port (full flow) shut-off in-line ball valves with PEX crimp, sweat or threaded connections. Compatible with all types of PEX tubing – A, B or C, manufactured to ASTM F876/F877 standards. PEX valves are designed to control water flow to plumbing fixtures with simple on/off water flow control to faucets, toilets, and home appliances. Controlling water flow at each fixture allows for maintenance and replacement of fixtures without the need to shut down the entire piping system. Designed for use with PEX crimp rings, stainless steel pinch clamps or stainless steel sleeves.

PEX Barb Ball Valve is a low-cost solution to control water flow. The single lever control allows for easy operation. Low-cost plumbing connection system.

Connection Methods

PEX crimp style connections on both sides on the valve. Approved for potable water use nationwide and compatible with all types (A, B, C) and brands of PEX. Can be connected to PEX pipe using either crimp or clamp (cinch) connection methods.

The ends of the PEX ball valves are the same as any ASTM F1807/F2159 crimp style PEX fittings.



Anping County KaiXuan Stainless Steel Products Co., Ltd.

Email: linda@quickcoupling.net.cn

Web: www.kxcasting.com

Office: 14F-1416, No.49 Zhaiying St, Yuhua District, Shijiazhuang, 050000

Factory: No.17 East industrial zone, Anping county, Hebei, 053600, China