



## **Stainless Steel Pipe Fittings and Ball Valves**

Web: [www.kxcasting.com](http://www.kxcasting.com)

Email: [info@hbkaixuan.com](mailto:info@hbkaixuan.com)

Office: 14F-1417, No.49 Zhaiying St, Yuhua District, Shijiazhuang, 050000

Factory: No.17 East industrial Park, Anping county, Hebei, 053600, China



We, a manufacturing and trading combo, produce and export pipe fittings and ball valves since 2002, especially focus on stainless steel pipe fittings and stainless steel ball valves.

We are the family owned team, Mr. Yan brothers established KX Co. (Anping county KaiXuan stainless steel products Co., Ltd) and built the plant in 2002. Mr. Yan brothers' younger generation heads KX Co.'s global business development, strategy, and marketing.

Every worker try their best to do the best pipe fittings and valves to serve and feedback to customers, all of us want to take this job constantly continue, we are the most stable fittings and valves supplier and reliable team of yours.

Delivering premium quality products at competitive prices. But, it's not the single reason why customers opt for KX Co. Selling a product is one thing; prompt and correct delivery is another. At KX Co., fast, reliable delivery and service quality are held in the highest regard. We are on a never-ending quest to develop new products for more customers.

We take on the future: optimal service & prompt, accurate delivery, just as our customers have come to expect from us: "Superior in price and quality!"

A good product speaks for itself that it's always the idea that values.



# Contents

3-18	<b>Stainless Steel Pipe Fittings 150#</b>
4-9	MSS-SP114 Heavy Pattern
10	Stainless Steel Hose Barb Fittings
11-18	Standard Pattern Stainless Steel Fittings
19	<b>Stainless Steel Pipe Nipples</b>
20-22	<b>Stainless Steel PEX Fittings</b>
23	<b>Stainless Steel PEX Ball Valves</b>
24-30	<b>Stainless Steel Ball Valves</b>
24	1PC BALL VALVES
25	2PC BALL VALVES
26	3PC BALL VALVES
27	2PC BALL VALVES WITH MOUNTING PAD
28	2PC BALL VALVES 2000WOG
29-30	3 WAY BALL VALVES



## Stainless Steel Pipe fittings 150#



- Stainless Steel 304 & 316 Available
- Casting Conforms to ASTM A351
- Thread: NPT, BSP, PT, Metric, etc.
- Pressure: 150PSI
- Threads Conform to ASME B1.20.1, DIN2999/259, ISO7/1, ISO228-1, JIS B 0203.
- Manufacturing Facility is ISO 9001:2008 Certified
- Fittings Meet Applicable Chemical & Physical Properties



## MSS SP 114 Heavy Pattern Stainless Steel Fittings

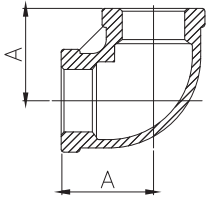

### ELBOW – 90°

Size	1/8	1/4	3/8	1/2	3/4	1
A(mm)	20.5	20.5	23.6	28.4	33.2	38.0
Size	1¼	1½	2	2½	3	4
A(mm)	44.4	49.0	57.0	62.7	71.9	89.7

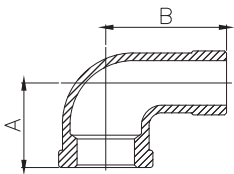

### STREET ELBOW – 90°

Size	1/8	1/4	3/8	1/2	3/4	1
A(mm)	20.5	20.5	23.6	28.4	33.2	38.1
B(mm)	26.9	29.9	36.3	41.1	47.4	53.8
Size	1¼	1½	2	2½	3	4
A(mm)	44.4	49.0	57.0	63.2	71.6	89.4
B(mm)	63.5	69.8	82.5	91.7	106.4	135.6

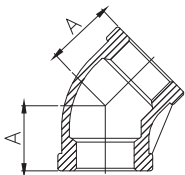

### ELBOW – 45°

Size	1/8	1/4	3/8	1/2	3/4	1
A(mm)	17.5	17.5	20.5	22.0	25.4	28.4
Size	1¼	1½	2	2½	3	4
A(mm)	33.2	36.3	42.6	47.0	52.07	64.0



MSS SP 114 Heavy Pattern Stainless Steel Fittings

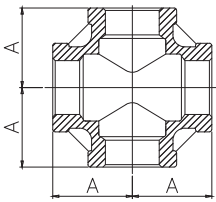

**CROSS**

Size	1/8	1/4	3/8	1/2	3/4	1
A(mm)	20.5	20.5	23.6	28.4	33.2	38.0
Size	1¼	1½	2	2½	3	4
A(mm)	44.4	49.0	57.0	62.7	71.9	89.6

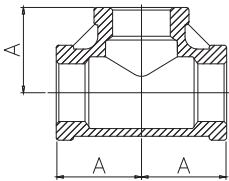

**TEE**

Size	1/8	1/4	3/8	1/2	3/4	1
A(mm)	20.5	20.5	23.6	28.4	33.2	38.0
Size	1¼	1½	2	2½	3	4
A(mm)	44.4	49.0	57.0	62.7	71.9	89.6

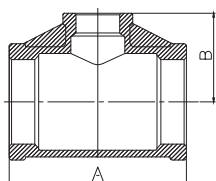

**REDUCING TEE**

Size	1/2*1/4	1/2*3/8	3/4*3/8	3/4*1/2	1*1/2	1*3/4	1¼*3/4
A(mm)	56.8	56.8	66.4	66.4	76.2	76.2	88.8
B(mm)	28.4	28.4	33.2	33.2	38.1	38.1	44.4
Size	1¼*1	1½*1	1½*1¼	2*1	2*1¼	2*1½	
A(mm)	88.8	98.0	98.0	114.3	114.3	114.3	
B(mm)	44.4	49.0	49.0	57.15	57.15	57.15	



## MSS SP 114 Heavy Pattern Stainless Steel Fittings

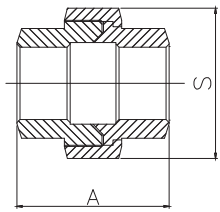

### UNION

Size	1/8	1/4	3/8	1/2	3/4	1
A(mm)	31.1	31.6	34.7	39.7	42.6	48.6
S(mm)	28.5	28.6	33.6	38.6	46.9	57.7
Size	1¼	1½	2	2½	3	4
A(mm)	53.9	58.8	63.2	70.6	79.1	91.6
S(mm)	66.7	76.0	89.6	107.4	122	151.5

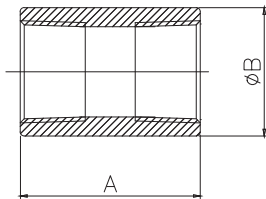

### FULL COUPLING

Size	1/8	1/4	3/8	1/2	3/4	1
A(mm)	21.0	24.7	28.2	34.2	38.0	42.5
φB(mm)	14.5	17.6	21.0	26.0	30.5	38.2
Size	1¼	1½	2	2½	3	4
A(mm)	48.2	51.7	56.0	66.0	71.2	82.0
φB(mm)	47.0	52.8	67.8	80.0	97.0	124.0

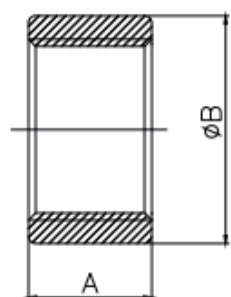
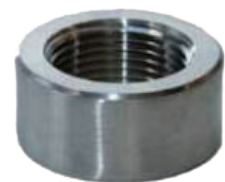

### HALF COUPLING

Size	1/8	1/4	3/8	1/2	3/4	1
A(mm)	12.9	13.2	14.5	18.0	19.3	20.8
φB(mm)	20.0	22.3	26.6	31.5	37.6	46.0
Size	1¼	1½	2	2½	3	4
A(mm)	25.6	27.2	32.0	36.8	40.9	47.5
φB(mm)	55.6	64.0	76.4	85.0	102.0	128.8

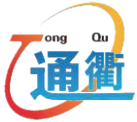

MSS SP 114 Heavy Pattern Stainless Steel Fittings

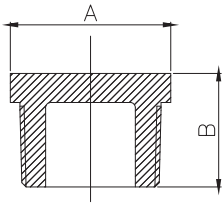

HEX PLUG

Size	1/8	1/4	3/8	1/2	3/4	1
A(mm)	12.7	15.7	17.2	22.0	30.4	36.3
B(mm)	12.8	14.6	16.1	19.0	21.5	25.3
Size	1¼	1½	2	2½	3	4
A(mm)	44.7	50.8	62.9	74.9	97.3	116.6
B(mm)	27.4	28.8	30.9	38.3	40.1	46.0

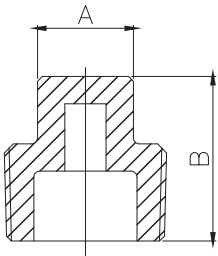

SQUARE HEAD PLUG

Size	1/8	1/4	3/8	1/2	3/4	1
A(mm)	7.0	9.5	11.0	14.2	15.8	20.6
B(mm)	15.3	18.2	19.9	23.8	27.1	31.7
Size	1¼	1½	2	2½	3	4
A(mm)	23.8	28.5	33.3	38.1	42.4	56.1
B(mm)	34.5	36.7	39.5	46.0	49.0	56.9

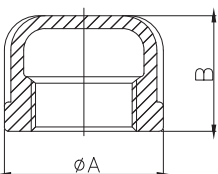

ROUND CAP

Size	1/8	1/4	3/8	1/2	3/4	1
φA(mm)	19.0	21.3	25.6	30.4	37.0	44.9
B(mm)	17.2	17.2	20.5	23.6	26.9	33.2
Size	1¼	1½	2	2½	3	4
φA(mm)	54.6	61.7	75.0	81.0	98.5	124.7
B(mm)	41.0	41.0	44.4	48.5	54.3	60.4





MSS SP 114 Heavy Pattern Stainless Steel Fittings

HEX BUSHING

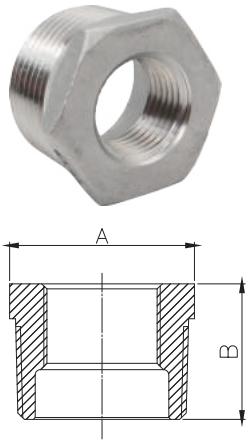

Size	1/2*1/8	1/2*1/4	1/2*3/8	3/4*1/4	3/4*3/8	3/4*1/2
A(mm)	22.1	22.1	22.1	26.8	26.8	26.8
B(mm)	19.0	19.0	19.0	21.3	21.3	21.3
Size	1*1/4	1*3/8	1*1/2	1*3/4	1 1/4*1/2	1 1/4*3/4
A(mm)	34.8	34.8	34.8	34.8	44.3	44.3
B(mm)	25.3	25.3	25.3	25.3	27.6	27.6
Size	1 1/4*1	1 1/2*3/4	1 1/2*1	1 1/2*1 1/4	2*3/4	2*1
A(mm)	44.3	50.7	50.7	50.7	63.4	63.4
B(mm)	27.6	28.2	28.2	28.2	30.8	30.8
Size	2*1 1/4	2*1 1/2	2 1/2*1/2	2 1/2*3/4	2 1/2*1	2 1/2*1 1/4
A(mm)	63.4	63.4	74.7	74.7	74.7	74.7
B(mm)	30.8	30.8	37.6	37.6	37.6	37.6
Size	2 1/2*1 1/2	2 1/2*2	3*1	3*1-1/4	3*1-1/2	3*2
A(mm)	74.7	74.7	92.2	92.2	92.2	92.2
B(mm)	37.6	37.6	40.1	40.1	40.1	40.1
Size	3*2-1/2	4*1-1/4	4*1-1/2	4*2	4*2-1/2	4*3
A(mm)	92.2	116.6	116.6	116.6	116.6	116.6
B(mm)	40.1	48.0	48.0	48.0	48.0	48.0

HEX NUT

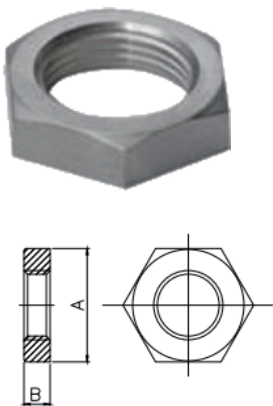

Size	1/8	1/4	3/8	1/2	3/4	1
A(mm)	18.0	21.8	25.9	33.8	36.6	44.4
B(mm)	5.3	6.6	7.8	8.4	9.1	9.6
Size	1 1/4	1 1/2	2	2 1/2	3	4
A(mm)	53.8	60.2	73.9	91.7	118.3	148.8
B(mm)	11.1	12.4	14.0	15.7	17.5	21.0



## MSS SP 114 Heavy Pattern Stainless Steel Fittings

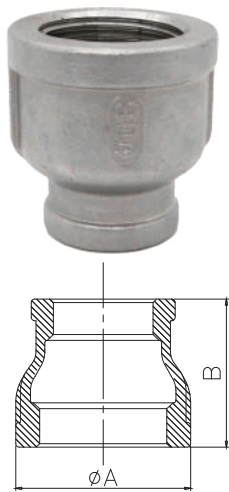

### REDUCING COUPLING

Size	1/4*1/8	1/2*1/4	1/2*3/8	3/4*1/4	3/4*3/8	3/4*1/2
φA(mm)	21.3	30.5	30.5	37.0	37.0	37.0
B(mm)	25.4	35.0	35.0	38.0	38.0	38.0
Size	1*3/8	1*1/2	1*3/4	1 1/4*1/2	1 1/4*3/4	1 1/4*1
φA(mm)	45.0	45.0	45.0	54.5	54.5	54.5
B(mm)	41.1	41.1	41.1	50.8	50.8	50.8
Size	1 1/2*1/2	1 1/2*3/4	1 1/2*1	1 1/2*1 1/4	2*3/4	2*1
φA(mm)	61.7	61.7	61.7	61.7	75.0	75.0
B(mm)	53.8	53.8	53.8	53.8	63.5	63.5
Size	2*1 1/4	2*1 1/2	2-1/2*1	2-1/2*1-1/4	2-1/2*1-1/2	2-1/2*2
φA(mm)	75.0	75.0	86.1	86.1	86.1	86.1
B(mm)	63.5	63.5	83.0	83.0	83.0	83.0
Size	3*1	3*1-1/4	3*1-1/2	3*2	3*2-1/2	4*2
φA(mm)	103.1	103.1	103.1	103.1	103.1	129.8
B(mm)	83.0	83.0	83.0	83.0	83.0	111.5
Size	4*2-1/2	4*3				
φA(mm)	129.8	129.8				
B(mm)	111.5	111.5				

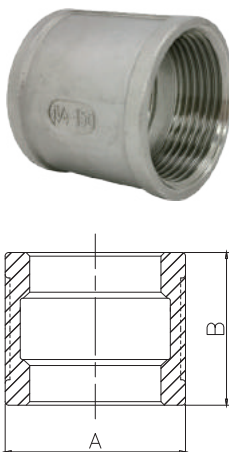

### SOCKET BANDED

Size	1/2	3/4	1	1 1/4	1 1/2	2
A(mm)	30.5	37.0	45.0	54.6	61.7	75.0
B(mm)	35.0	38.0	41.1	50.8	53.8	63.5



## Stainless Steel Hose Barb Fitting

### HOSE BARB FITTING

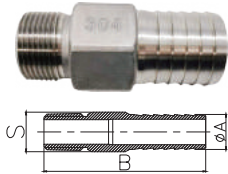

Size	1/2B*1/2M	3/4B*1/2M	3/4B*3/4M	1B*3/4M	1B*1M	1 1/4B*1M
A(mm)	16.8	21.5	21.5	27.2	27.2	36.0
B(mm)	72.6	74.0	75.0	85.0	86.2	90.6
S(mm)	19.0	26.0	26.0	30.6	30.6	40.0
Size	1 1/4B*1 1/4M	1 1/2B*1 1/2M	2B*2M			
A(mm)	36.0	41.7	53.6			
B(mm)	95.3	97.6	101.8			
S(mm)	40.0	46.5	58.0			

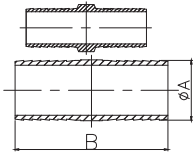

### HOSE BARB COUPLING

Size	1/2B*1/2B	3/4B*3/4B	1B*1B	1 1/4B*1 1/4B	1 1/2B*1 1/2B	2B*2B
φA(mm)	16.8	21.5	27.2	36.0	41.8	53.6
B(mm)	83.2	81.0	86.0	81.8	95.0	107.0

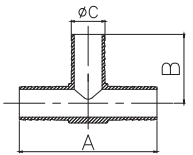

### HOSE BARB TEE

Size	3/4B*3/4B*3/4B	1B*1B*1B	1 1/4B*1 1/4B*1 1/4B
A(mm)	92.0	106.0	124.4
B(mm)	46.0	53.0	62.2
φC(mm)	21.5	27.2	36.0

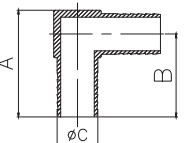

### HOSE BARB ELBOW

Size	3/4B*3/4B*3/4B	1B*1B*1B	1 1/4B*1 1/4B*1 1/4B
A(mm)	59.0	68.0	81.2
B(mm)	46.0	53.0	62.2
φC(mm)	21.5	27.2	36.0



## Standard Pattern Stainless Steel Fittings

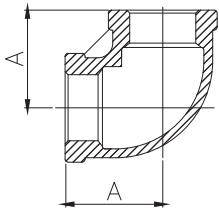

### ELBOW – 90°

Size	1/8	1/4	3/8	1/2	3/4	1
A(mm)	16.8	18.9	22.6	26.6	30.8	36.2
Size	1¼	1½	2			
A(mm)	41.9	47.2	56.0			

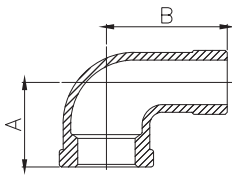

### STREET ELBOW – 90°

Size	1/8	1/4	3/8	1/2	3/4	1
A(mm)	15.6	18.0	20.0	25.0	29.0	35.4
B(mm)	24.3	27.8	32.0	38.0	44.0	50.7
Size	1¼	1½	2			
A(mm)	41.0	45.8	53.0			
B(mm)	57.0	62.5	72.0			

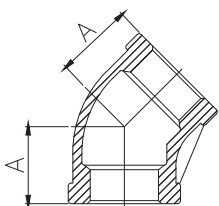

### ELBOW – 45°

Size	1/8	1/4	3/8	1/2	3/4	1
A(mm)	15.6	15.9	17.6	19.2	22.8	26.7
Size	1¼	1½	2	2½	3	4
A(mm)	30.0	32.7	38.6	44.6	50.6	59.5

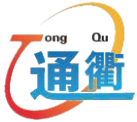

## Standard Pattern Stainless Steel Fittings

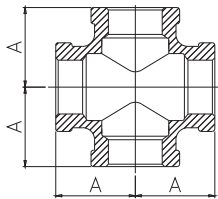

### CROSS

Size	1/8	1/4	3/8	1/2	3/4	1
A(mm)	16.5	18.6	22.6	26.4	30.2	36.2
Size	1¼	1½	2			
A(mm)	41.9	46.6	55.4			

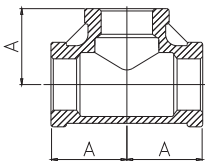

### TEE

Size	1/8	1/4	3/8	1/2	3/4	1
A(mm)	16.5	18.6	22.6	26.4	30.2	36.1
Size	1¼	1½	2			
A(mm)	41.9	46.6	55.4			

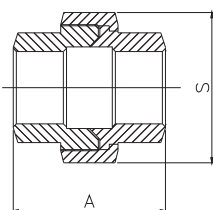

### UNION

Size	1/8	1/4	3/8	1/2	3/4	1
A(mm)	31.1	31.6	34.7	39.7	42.6	48.6
S(mm)	28.5	28.6	33.6	38.6	46.9	57.7
Size	1¼	1½	2	2½	3	4
A(mm)	53.9	58.8	63.2	70.6	79.1	91.6
S(mm)	66.7	76.0	89.6	107.4	122.0	151.5



Standard Pattern Stainless Steel Fittings

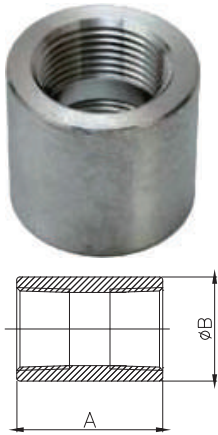

FULL COUPLING

Size	1/8	1/4	3/8	1/2	3/4	1
A(mm)	21.0	24.7	28.2	34.2	38.0	42.5
φB(mm)	14.5	17.6	21.0	26.0	30.5	38.2
Size	1¼	1½	2	2½	3	4
A(mm)	48.2	51.7	56.0	66.0	71.2	82.0
φB(mm)	47.0	52.8	67.8	80.0	97.0	124.0

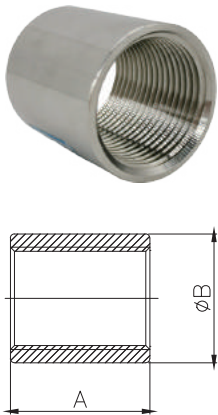

FULL COUPLING

Size	1/8	1/4	3/8	1/2	3/4	1
A(mm)	17.8	23.5	25.5	33.8	35.0	42.5
φB(mm)	13.2	17.2	21.7	25.5	30.0	36.7
Size	1¼	1½	2	2½	3	4
A(mm)	47.5	49.5	55.4	64.0	70.0	78.5
φB(mm)	47.0	53.0	65.2	82.5	95.5	124.0

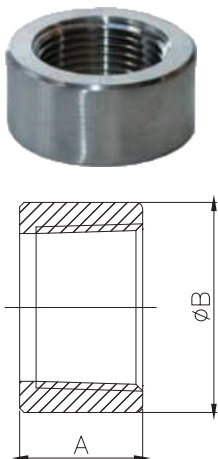

HALF COUPLING

Size	1/8	1/4	3/8	1/2	3/4	1
A(mm)	8.0	11.0	12.0	15.0	17.0	19.5
φB(mm)	14.5	17.6	21.0	26.0	30.5	38.2
Size	1¼	1½	2	2½	3	4
A(mm)	22.0	22.0	26.0	30.5	34.0	40.0
φB(mm)	47.0	52.8	67.8	80.0	97.0	124.0



## Standard Pattern Stainless Steel Fittings

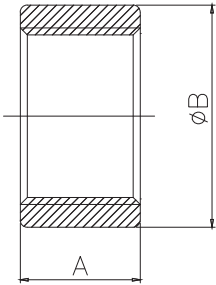

### HALF COUPLING

Size	1/8	1/4	3/8	1/2	3/4	1
A(mm)	8.0	11.0	11.4	15.0	16.3	19.2
$\phi B$ (mm)	13.2	17.2	21.7	25.5	30.0	36.7
Size	1 1/4	1 1/2	2	2 1/2	3	4
A(mm)	21.4	21.4	25.7	30.5	33.5	40.0
$\phi B$ (mm)	47.0	53.0	65.2	82.5	95.5	124.0

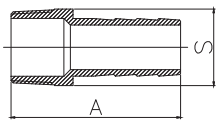

### HOSE NIPPLE

Size	1/4	3/8	1/2	3/4	1	1 1/4
A(mm)	42.3	47.0	59.7	67.0	78.0	82.7
S(mm)	16.0	19.0	23.5	28.4	35.2	44.0
Size	1 1/2	2				
A(mm)	86.7	105.5				
S(mm)	50.0	62.5				

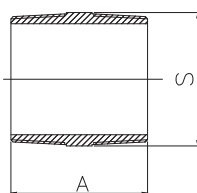

### HEX NIPPLE

Size	1/4	3/8	1/2	3/4	1	1 1/4
A(mm)	30.0	32.7	37.5	40.5	48.5	53.0
S(mm)	16.0	19.0	23.5	28.4	35.2	44.0
Size	1 1/2	2				
A(mm)	54.0	64.0				
S(mm)	50.0	62.5				



## Standard Pattern Stainless Steel Fittings

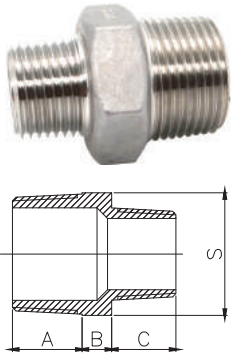

### REDUCING HEX NIPPLE

Size	1/4*1/8	3/8*1/8	3/8*1/4	1/2*1/4	1/2*3/8	3/4*1/4
A(mm)	12.0	12.5	12.5	14.0	14.0	16.5
B(mm)	5.5	5.5	5.5	6.0	6.0	7.0
C(mm)	10.5	10.5	12.0	12.0	12.5	12.0
S(mm)	14.5	18.0	18.0	22.5	22.5	28.0
Size	3/4*3/8	3/4*1/2	1*3/8	1*1/2	1*3/4	1 1/4*1/2
A(mm)	16.5	16.5	18.5	18.5	18.5	21.0
B(mm)	7.0	7.0	7.0	7.0	7.0	7.0
C(mm)	12.5	14.0	12.5	14.0	16.5	14.0
S(mm)	28.0	28.0	34.5	34.5	34.5	43.0
Size	1 1/4*3/4	1 1/4*1	1 1/2*1/2	1 1/2*3/4	1 1/2*1	1 1/2*1 1/4
A(mm)	21.0	21.0	22.0	22.0	22.0	22.0
B(mm)	7.0	7.0	8.0	8.0	8.0	8.0
C(mm)	16.5	18.5	14.0	16.5	18.5	21.0
S(mm)	43.0	43.0	49.5	49.5	49.5	49.5
Size	2*3/4	2*1	2*1 1/4	2*1 1/2		
A(mm)	24.0	24.0	24.0	24.0		
B(mm)	8.0	8.0	8.0	8.0		
C(mm)	16.5	18.5	21.0	22.0		
S(mm)	62.0	62.0	62.0	62.0		

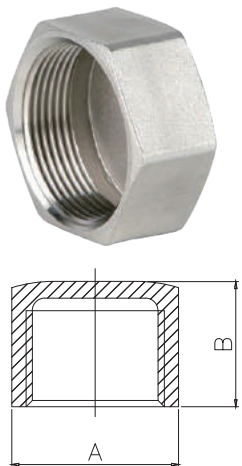

### HEX CAP

Size	1/8	1/4	3/8	1/2	3/4	1
A(mm)	13.5	15.4	19.7	26.2	31.9	39.8
B(mm)	15.4	15.5	18.0	23.5	24.6	29.9
Size	1 1/4	1 1/2	2			
A(mm)	47.8	55.9	66.5			
B(mm)	30.6	32.5	35.6			





Standard Pattern Stainless Steel Fittings

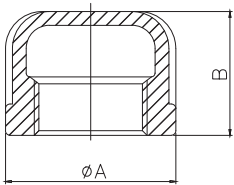

**ROUND CAP**

Size	1/8	1/4	3/8	1/2	3/4	1
φA(mm)	14.5	17.4	20.7	27.5	32.5	40.0
B(mm)	13.9	15.0	16.9	19.7	23.3	27.6
Size	1¼	1½	2	2½	3	4
φA(mm)	49.0	55.4	68.2	84.4	98.1	122.8
B(mm)	29.6	30.5	35.0	40.5	41.2	45.4

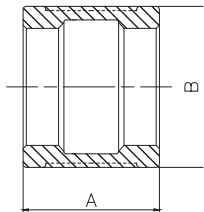

**SOCKET BANDED**

Size	1/8	1/4	3/8	1/2	3/4	1
A(mm)	18.2	25.0	26.0	32.6	35.0	41.0
φB(mm)	14.0	17.2	21.2	26.0	32.0	39.6
Size	1¼	1½	2	2½	3	4
A(mm)	44.0	44.4	51.0	63.5	70.2	79.0
φB(mm)	48.2	54.5	67.2	83.6	98.0	123.0

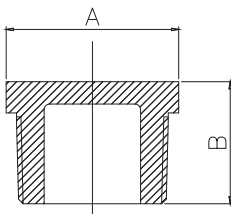

**HEX HEAD PLUG**

Size	1/4	3/8	1/2	3/4	1	1¼
A(mm)	16.0	19.0	23.5	28.4	35.2	44.0
B(mm)	18.3	19.7	22.5	24.2	28.5	31.3
Size	1½	2				
A(mm)	50.0	62.5				
B(mm)	32.3	38.0				



## Standard Pattern Stainless Steel Fittings

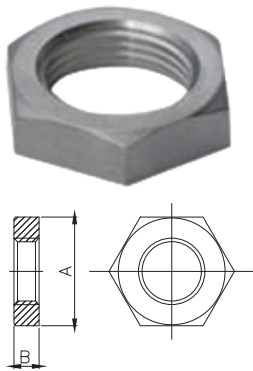

### LOCK NUT

Size	1/8	1/4	3/8	1/2	3/4	1
A(mm)	14.0	21.8	26.8	31.8	35.8	45.8
B(mm)	6.0	7.0	8.0	9.3	9.5	10.0
Size	1¼	1½	2			
A(mm)	55.0	60.0	74.5			
B(mm)	11.0	12.0	13.0			

### HEX BUSHING

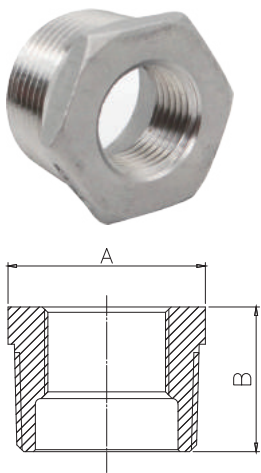

Size	1/4*1/8	3/8*1/8	3/8*1/4	1/2*1/8	1/2*1/4	1/2*3/8
A(mm)	16.8	20.8	20.8	22.8	22.8	22.8
B(mm)	18.2	19.0	19.0	22.0	22.0	22.0
Size	3/4*1/4	3/4*3/8	3/4*1/2	1*3/8	1*1/2	1*3/4
A(mm)	27.7	27.7	27.7	35.2	35.2	35.2
B(mm)	24.0	24.0	24.0	25.0	25.0	25.0
Size	1¼*1/2	1¼*3/4	1¼*1	1½*3/4	1½*1	1½*1¼
A(mm)	43.7	43.7	43.7	49.3	49.3	49.3
B(mm)	30.0	30.0	30.0	30.3	30.3	30.3
Size	2*3/4	2*1	2*1¼	2*1½		
A(mm)	61.0	61.0	61.0	61.0		
B(mm)	32.4	32.4	32.4	32.4		



## Standard Pattern Stainless Steel Fittings

### REDUCING COUPLING

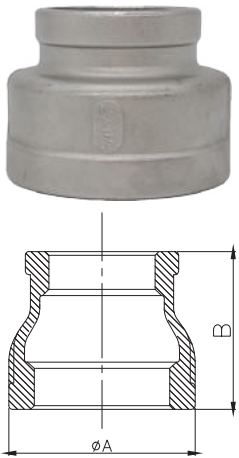

Size	1/4*1/8	3/8*1/8	3/8*1/4	1/2*1/4	1/2*3/8	3/4*1/4
φA(mm)	17.6	21.6	21.6	26.2	26.2	32.3
B(mm)	24.0	24.0	28.0	30.3	30.3	31.5
Size	3/4*3/8	3/4*1/2	1*3/8	1*1/2	1*3/4	1 1/4*1/2
φA(mm)	32.3	32.3	39.7	39.7	39.7	48.6
B(mm)	31.5	33.8	34.5	36.8	38.0	38.3
Size	1 1/4*3/4	1 1/4*1	1 1/2*1/2	1 1/2*3/4	1 1/2*1	1 1/2*1 1/4
φA(mm)	48.6	48.6	56.0	56.0	56.0	56.0
B(mm)	39.5	42.5	38.3	39.5	42.5	44.0
Size	2*3/4	2*1	2*1 1/4	2*1 1/2		
φA(mm)	68.0	68.0	68.0	68.0		
B(mm)	43.0	46.0	47.5	47.5		

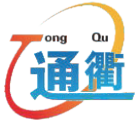

## Stainless Steel Pipe Nipples



Plain End



Bevel End

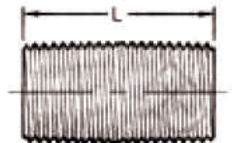

Close Nipple

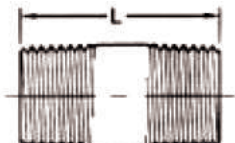

Short Nipple



Long Nipple

### PIPE NIPPLES THREADED

Size		1/8	1/4	3/8	1/2	3/4
L	Close Nipple	3/4	7/8	1	1-1/8	1-3/8
	Short Nipple	1-1/2	1-1/2	1-1/2	1-1/2	2
	Long Nipple	2~12	2~12	2~12	2~12	2-12~12
Plain End Weight (kg/m)	Sch40/STD	0.37	0.63	0.84	1.27	1.69
	Sch80/XS	0.47	0.80	1.10	1.62	2.20
	Sch160	/	/	/	1.95	2.90
	XXS	/	/	/	2.55	3.64
Size		1	1 1/4	1 1/2	2	2 1/2
L	Close Nipple	1-1/2	1-5/8	1-3/4	2	2-1/2
	Short Nipple	2	2-1/2	2-1/2	2-1/2	3
	Long Nipple	2-12~12	3~12	3~12	3~12	3-1/2~12
Plain End Weight (kg/m)	Sch40/STD	2.50	3.39	4.05	5.44	8.63
	Sch80/XS	3.24	4.47	5.41	7.48	11.41
	Sch160	4.24	5.61	7.25	11.11	14.92
	XXS	5.45	7.77	9.55	13.44	20.39
Size		3	3 1/2	4	5	6
L	Close Nipple	2-5/8	2-3/4	2-7/8	3	3-1/8
	Short Nipple	3	4	4	4-1/2	4 1/2
	Long Nipple	3-1/2~12	4-1/2~12	4-1/2~12	5~12	5~12
Plain End Weight (kg/m)	Sch40/STD	11.29	13.57	16.08	21.77	28.26
	Sch80/XS	15.27	18.64	22.32	30.97	42.56
	Sch160	21.35	/	33.54	49.12	67.57
	XXS	27.68	/	41.03	57.43	79.22

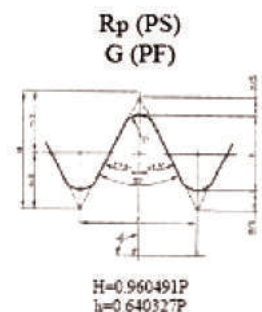
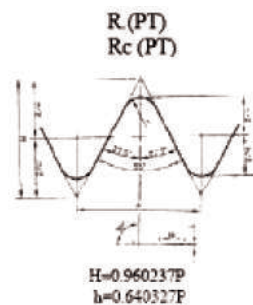
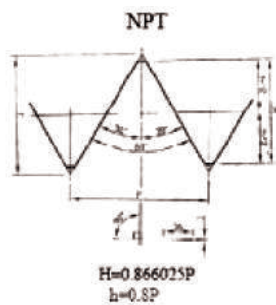

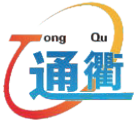

## Stainless Steel PEX Fittings

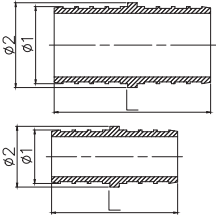

### PEX COUPLING

Size	1/2P*1/2P	3/4P*3/4P	1P*1P
$\phi 1$ (mm)	12.0	17.0	21.8
$\phi 2$ (mm)	14.0	19.0	24.0
L(mm)	35.0	35.0	44.0

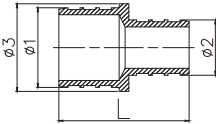

### PEX REDUCING COUPLING

Size	3/4P*1/2P	1P*3/4P
$\phi 1$ (mm)	17.0	21.8
$\phi 2$ (mm)	12.0	17.0
$\phi 3$ (mm)	19.0	24.0
L(mm)	35.6	40.0

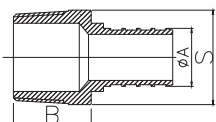

### PEX MALE ADAPTER

Size	1/2P*3/4M	1/2P*1/2M	3/4P*1/2M	3/4P*3/4M	1P*3/4M	1P*1M
$\phi A$ (mm)	12.0	12.0	17.0	17.0	21.7	21.7
B(mm)	42.5	42.4	42.5	42.4	47.0	48.0
S(mm)	27.0	22.0	22.0	27.0	27.0	35.0



## Stainless Steel PEX Fittings

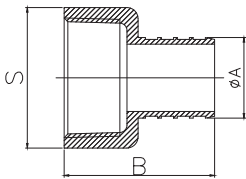

### PEX FEMALE ADAPTER

Size	1/2P*3/4F	1/2P*1/2F	3/4P*1/2F	3/4P*3/4F	1P*1F
φA(mm)	12.0	12.0	17.0	17.0	21.8
B(mm)	34.5	34.5	34.0	34.5	40.7
S(mm)	31.0	25.0	25.0	31.0	38.0

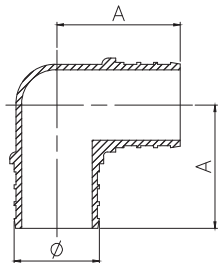

### PEX ELBOW

Size	1/2P*1/2P	3/4P*3/4P	1P*1P
A(mm)	24.2	26.5	35.0
φ(mm)	12.0	17.0	21.8

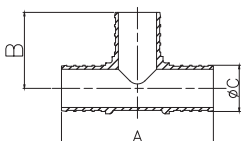

### PEX TEE

Size	1/2P*1/2P*1/2P	3/4P*3/4P*3/4P	1P*1P*1P
A(mm)	48.3	53.0	70.0
B(mm)	24.15	26.5	35.0
φC(mm)	12.0	17.0	21.8



## Stainless Steel PEX Fittings

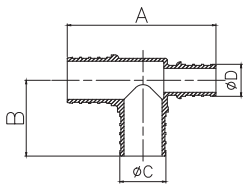

### PEX REDUCING TEE

Size	3/4P*1/2P*1/2P	3/4P*1/2P*3/4P	1P*3/4P*3/4P	1P*1/2P*1P	1P*3/4P*1P
A(mm)	53.3	53.6	67.0	67.0	67.0
B(mm)	26.3	27.0	32.0	35.0	35.0
$\phi$ C(mm)	17.0	17.0	21.8	21.8	21.8
$\phi$ D(mm)	12.0	12.0	17.0	12.0	17.0

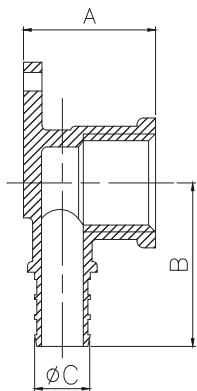

### PEX DROP EAR ELBOW

Size	1/2P*1/2F	3/4P*3/4F
A(mm)	28.5	31.9
B(mm)	35.2	37.2
$\phi$ C(mm)	12.0	17.0

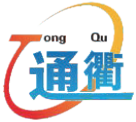

## Stainless Steel PEX Ball Valve

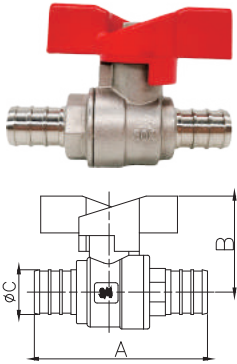

### PEX BALL VALVE

Size	1/2P*1/2P	3/4P*3/4P	1P*1P
A(mm)	62.5	65.8	77.1
B(mm)	33.3	36.0	40.0
φC(mm)	12.0	17.0	21.8

#### **Stainless Steel PEX Ball Valves**

Material: Stainless Steel 304, 316, 1.4308, 1.4408, CF8, CF8M

End Connection: PEX/Crimp

PEX Valve Type: Crimp

PEX Tubing Compatibility: PEX types A, B, C

Medium: Water, Oil, Gas, Corrosive liquid

Process: Precision Investment Casting

Casting Conforms to ASTM A351, etc.

Pressure: 400 PSI

Size: 1/2" 3/4" 1"

Stainless Steel PEX ball valves are full port (full flow) shut-off in-line ball valves with PEX crimp, sweat or threaded connections. Compatible with all types of PEX tubing – A, B or C, manufactured to ASTM F876/F877 standards. PEX valves are designed to control water flow to plumbing fixtures with simple on/off water flow control to faucets, toilets, and home appliances. Controlling water flow at each fixture allows for maintenance and replacement of fixtures without the need to shut down the entire piping system. Designed for use with PEX crimp rings, stainless steel pinch clamps or stainless steel sleeves.

PEX Barb Ball Valve is a low-cost solution to control water flow. The single lever control allows for easy operation. Low-cost plumbing connection system.

#### **Connection Methods**

PEX crimp style connections on both sides on the valve. Approved for potable water use nationwide and compatible with all types (A, B, C) and brands of PEX. Can be connected to PEX pipe using either crimp or clamp (cinch) connection methods.

The ends of the PEX ball valves are the same as any ASTM F1807/F2159 crimp style PEX fittings.





## Stainless Steel Ball Valve

### 1PC BALL VALVES

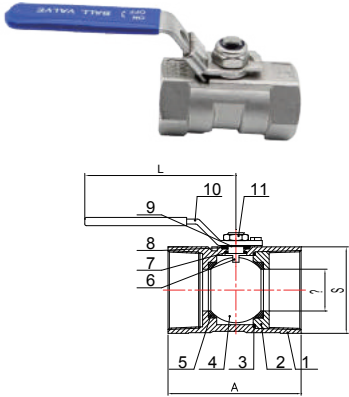

Size	1/4	3/8	1/2	3/4	1
A(mm)	39.0	44.0	56.5	58.5	71.0
S(mm)	17.0	21.0	25.0	32.0	38.0
φ(mm)	4.6	6.8	9.2	12.5	15.0
L(mm)	59.0	79.0	85.0	87.0	99.0
Size	1¼	1½	2	2½	3
A(mm)	78.0	83.0	100.0	122.0	142.0
S(mm)	49.0	53.0	65.0	83.0	98.0
φ(mm)	20.0	25.0	32.0	38.0	50.0
L(mm)	99.0	126.0	126.0	176.0	176.0

No.	Part Name	Qty	Material
1	Body	1	304/316
2	Body Insert	1	304/316
3	Joint Gasket	1	PTFE
4	Ball	1	304/316
5	Joint Gasket	2	PTFE
6	Stem	1	304/316
7	Thrust Washer	1	PTFE
8	Stem Packing	1	PTFE
9	Stem Washer	1	304/316
10	Handle	1	304/316
11	Gland Nut	1	304/316

### Features

Material: Stainless Steel 304, 316, 1.4308, 1.4408, CF8, CF8M

Thread type: NPT, BSP, PT, Metric, etc.

Thread Standards: ASME B1.20.1 BS21, DIN2999/259, ISO7-1, ISO228-1, JIS B 0203

Pressure: 1000PS/1000WOG

Pattern: Reduce Port

Option: Locking device available

Inspection Testing: API598, EN12266

Connection: Thread

Medium: Water, Oil, Gas

Process: Investment Casting

Working temperature: -10-180 °C

Size: 1/4" to 4" (DN8 to DN100)

100% individually tested



## Stainless Steel Ball Valve

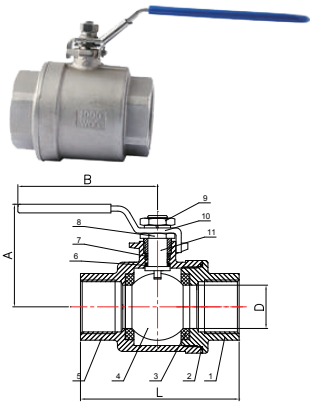

### 2PC BALL VALVES

Size	1/4	3/8	1/2	3/4	1
A(mm)	48.2	48.8	52.7	60.6	65.7
B(mm)	97.5	97.5	97.5	116.5	116.5
D(mm)	11.0	12.5	15.0	20.0	25.0
L(mm)	47.2	48.8	58.6	65.9	77.2
Size	1¼	1½	2	2½	3
A(mm)	77.9	82.7	100.8	124.0	138.0
B(mm)	153.0	153.0	192.0	248.0	248.0
D(mm)	32.0	38.0	50.0	64.0	76.0
L(mm)	90.5	98.2	121.5	145.4	167.7

No.	Part Name	Qty	Material
1	Cap	1	304/316
2	Joint Gasket	1	PTFE
3	Ball Seat	2	PTFE
4	Ball	1	304/316
5	Body	1	304/316
6	Thrust Washer	1	PTFE
7	Stem Packing	1	PTFE
8	Gland Nut	1	304/316
9	Spring Nut	1	304/316
10	Handle	1	304/316
11	Stem	1	304/316

### Features

Material: Stainless Steel 304, 316, 1.4308, 1.4408, CF8, CF8M  
 Thread Standards: ASME B1.20.1 BS21, DIN2999/259, ISO7-1, ISO228-1, JIS B 0203  
 Connection: Thread (Female/Male)  
 Thread type: NPT, BSP, PT, Metric, etc.  
 Medium: Water, Oil, Gas, etc.  
 Process: Investment Casting  
 Pressure Rating: 1000PS/1000WOG

Working temperature: -10-180 °C  
 Pattern: Full Port  
 Locking Device: Handle has a device to lock in the open or closed position (It can be easily removed)  
 Size: 1/4" to 4" (DN8 to DN100)  
 100% leak tested  
 Inspection Testing: API598, EN12266  
 2 PC ball valves are the most popular valves



## Stainless Steel Ball Valve

### 3PC BALL VALVES

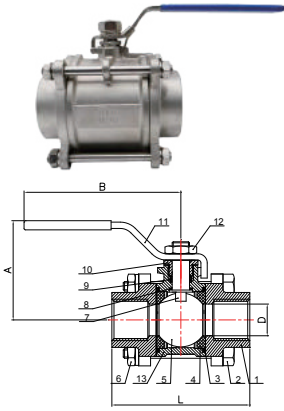

Size	1/4	3/8	1/2	3/4	1
A(mm)	45.5	45.5	48.0	61.5	68.0
B(mm)	99.5	99.5	99.5	126.5	126.5
D(mm)	12.5	12.5	15.0	20.0	25.0
L(mm)	57.5	59.0	62.8	78.0	82.2
Size	1 1/4	1 1/2	2	2 1/2	3
A(mm)	79.0	86.5	94.5	119.5	130.0
B(mm)	153.0	153.0	192.0	248.0	248.0
D(mm)	32.0	38.0	50.0	64.0	76.0
L(mm)	97.6	107.6	119.7	167.2	175.6

No.	Part Name	Qty	Material
1	Cap	2	304/316
2	Bolts	4	304/316
3	Body Seal	2	PTFE
4	Ball Seat	2	PTFE
5	Ball	1	304/316
6	Nut	4	304/316
7	Stem	1	304/316
8	Thrust Washer	1	PTFE
9	Stem Washer	1	PTFE
10	Gland Nut	1	304/316
11	Handle	1	304/316
12	Stem Nut	1	304/316
13	Body	1	304/316

#### Features

Material: Stainless Steel 304, 316, 1.4308, 1.4408, CF8, CF8M

Thread Standards: ASME B1.20.1 BS21.DIN2999/259, ISO228-1, JIS B 0203, ISO7/1

Connection: Thread, Welded

Thread type: NPT, BSP, BSPT, etc.

Medium: Water, Oil, Gas

Investment Casting

Pressure: 1000PSI/PN63

Pattern: Full port design

Size: 1/4" to 4" (DN8 to DN100)

Locking device available

Working temperature: -20-180

100% individually tested

Inspection Testing:API598,EN12266



## Stainless Steel Ball Valve

### 2PC BALL VALVES WITH MOUNTING PAD

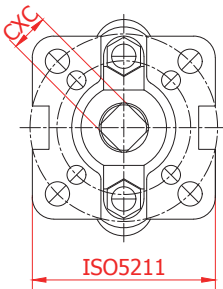
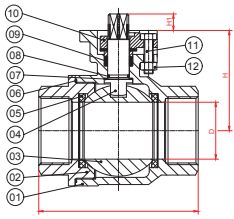

Size	1/2	3/4	1	1¼	1½	2
D(mm)	15.0	20.0	25.0	32.0	38.0	50.0
L(mm)	62.0	74.0	86.0	99.0	109.0	122.0
H(mm)	48.5	53.5	58.5	71.0	76.0	83.5
H1(mm)	7.0	7.0	11.0	11.0	14.0	14.0
C(mm)	7.0	7.0	11.0	11.0	14.0	14.0

No.	Part Name	Material
1	Body	CF8/M
2	End cap	CF8/M
3	Ball	304/316
4	Stem	304/316
5	Seat	PTFE
6	Gasket	PTFE
7	Thrust Washer	PTFE
8	Stem o-ring	VITON
9	Packing	PTFE
10	Gland	CF8
11	Bolt	304
12	Nut	304

#### Features

Material: Stainless Steel 304, 316, 1.4308, 1.4408, CF8, CF8M

Thread Standards: ASME B1.20.1 BS21, DIN2999/259, ISO7-1, ISO228-1, JIS B 0203

Connection: Thread

Thread type: NPT, BSP, PT, Metric, etc.

Medium: Water, Oil, Gas

Two-Piece Investment cast body

ISO5211 Mounting pad

Process: Investment Casting

Silicone Free

Full Port for unobstructed flow

Pressure up to 1000PSI

100% individually tested

Inspection Testing: API598, EN12266

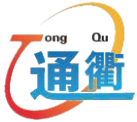

## Stainless Steel Ball Valve

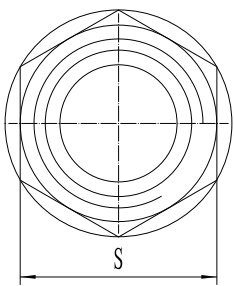
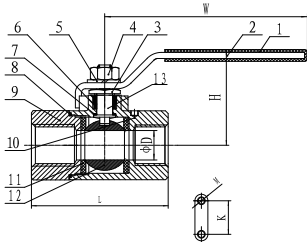

### 2PC Ball Valve 2000WOG

Size	1/4	3/8	1/2	3/4	1	1¼	1½	2
D(mm)	11.0	12.5	12.5	17.5	22.0	25.0	32.0	38.0
L(mm)	58.0	58.0	58.0	79.6	86.0	103.0	111.0	137.0
H(mm)	48.0	48.0	48.0	67.0	70.0	85.0	90.0	95.0
W(mm)	105.0	105.0	105.0	110.0	125.0	150.0	150.0	190.0
S(mm)	26.5	26.5	26.5	32.0	41.0	50.0	55.0	70.0
K(mm)	27.5	27.5	27.5	34.8	34.8	34.8	34.8	34.8
M	10-32UN	10-32UN	10-32UN	10-32UN	10-32UN	10-32UN	10-32UN	10-32UN

No.	ITEM	Material
1	PLASTIC COVER	PLASTIC
2	HANDLE	304
3	GLAND NUT	304
4	STEM NUT	304
5	SPRING WASHER	304
6	STEM PACKING	PTFE
7	THUST WASHER	PTFE
8	JOINT GASKET	PTFE
9	CAP	CF8/CF8M
10	BODY	CF8/CF8M
11	BALL STEAT	PTFE
12	BALL	CF8/CF8M
13	STEM	304/316

#### Features

Material: Stainless Steel 304, 316, 1.4308, 1.4408, CF8, CF8M

Thread Standards: ASME B1.20.1 BS21, DIN2999/259, ISO7-1, ISO228-1, JIS B 0203

Connection: Thread (Female/Male)

Thread type: NPT, BSP, PT, Metric, etc.

Medium: Water, Oil, Gas

Process: Investment Casting

Process: Investment Casting

Pressure Rating: 2000PSI/2000WOG

Working temperature: -10-180 °C

Pattern: Full Port

Locking Device: Handle has a device to lock in the open or closed position (It can be easily removed)

100% leak tested

Inspection Testing: API598, EN12266



## Stainless Steel Ball Valve

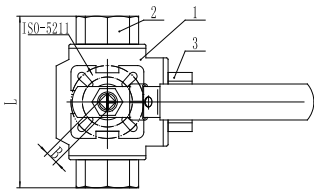
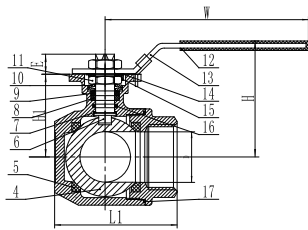

### 3 WAY BALL VALVE

Size	1/4	3/8	1/2	3/4	1	1 1/4
φD(mm)	9.0	11.0	12.5	16.0	20.0	25.0
W±2(mm)	143.0	143.0	143.0	143.0	163.0	163.0
L±2(mm)	79.0	79.0	79.0	83.0	102.0	120.0
L1±2(mm)	64.0	64.0	64.0	68.0	82.0	90.0
H±2(mm)	76.0	76.0	76.0	80.0	95.0	98.0
B(mm)	9.0	9.0	9.0	9.0	11.0	11.0
E±1(mm)	9.0	9.0	9.0	9.0	11.0	11.0
ISO5211	F04/03	F04/03	F04/03	F04/03	F05/04	F05/04
H1(mm)	42.0	42.0	42.0	49.0	59.5	63.0
Size	1 1/2	2	2 1/2	3	4	
φD(mm)	32.0	38.0	48.0	65.0	75.0	
W±2(mm)	188.0	188.0	343.0	343.0	343.0	
L±2(mm)	126.0	150.0	168.0	198.0	252.0	
L1±2(mm)	107.0	124.0	135.0	166.0	207.0	
H±2(mm)	110.0	119.0	135.0	150.0	161.0	
B(mm)	14.0	14.0	17.0	17.0	17.0	
E±1(mm)	14.0	14.0	15.6	20.0	28.0	
ISO5211	F07/05	F07/05	F07/10	F07/10	F07/10	
H1(mm)	73.5	82.8	103.5	118.0	130.0	

#### Features

Material: Stainless Steel 304, 316, 1.4308, 1.4408, CF8, CF8M

Thread Standards: ASME B1.20.1 BS21, DIN2999/259, ISO7-1, ISO228-1, JIS B 0203

Connection: Thread

Thread type: NPT, BSP, PT, Metric, etc.

Medium: Water, Oil, Gas

Process: Investment Casting

Pressure Rating: 1000PSI/1000WOG

Working temperature: -10-180 °C

Pattern: Full Port

ISO5211 Mounting Pad

Optional locked device handle

100% leak tested

Inspection Testing: API598, EN12266



## Stainless Steel Ball Valve



### 3 WAY BALL VALVE

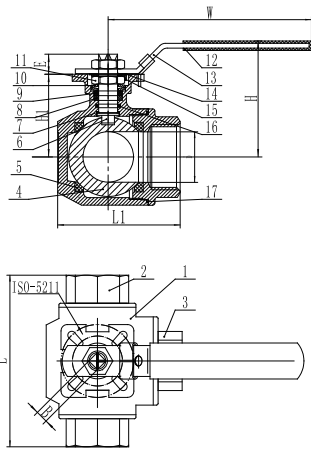

No.	ITEM	QTY	Material
1	BODY	1	CF8/CF8M/WCB
2	CAP(1)	2	CF8/CF8M/WCB
3	CAP(2)	1	CF8/CF8M/WCB
4	BALL	1	CF8/CF8M
5	BALL SEAT	4	PTFE
6	STEM	1	304/316
7	STEM SEAL	1	PTFE
8	STEM PACKING	1	PTFE
9	GLAND NUT	1	304
10	SPRING WASHER	2	304
11	NUT	2	304
12	PLASTIC COVER	1	PLASTIC
13	HANDLE	1	304
14	WASHER	1	304
15	THRUST WASHER	1	304
16	O-RING	1	VITON
17	BODY PACKING	1	PTFE

# 两片式德标球阀（轻体）

# KX VALVE

## 2-PC BALL VALVE -DIN3202-M3

WWW.KXCASTING.COM info@hbkaixuan.com

设计标准 (DESIGN STANDARD) : ASME B16.34 GB/T12237

螺纹标准 (THREADED ENDS) : BSP、DIN259、DIN EN ISO228、

产品型号 (PRODUCT STYLE) : Q11F-1000WOG (P/R)

公称压力 (WORKING PRESSURE) : PN63

适用温度 (TEMPERATURE RANGE) : -20°C~180°C

材 质 (MATERIAL) : ASTM-A351-CF8M、ASTM-A351-CF8

检验标准 (TEST&INSPECTION) : API598 JB/T9092

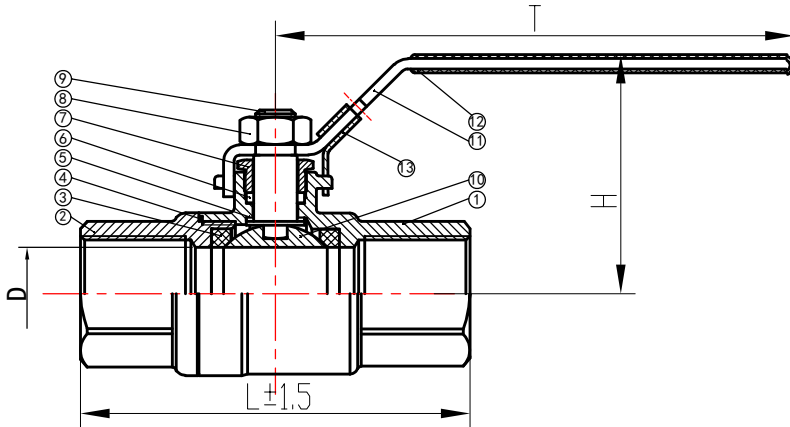

### 主要零部件材料 (MAIN PARTS MATERIALS) :

序号 NO.	零件名称 PART NAME	材质 MATERIAL	数量 QTY
1	阀体 BODY	CF8/CF8M	1
2	阀盖 CAP	CF8/CF8M	1
3	阀座 SEAT	PTFE/RPTFE	2
4	密封圈 JOINT GASKET	PTFE/RPTFE	1
5	止推垫圈 THRUST WASHER	PTFE/RPTFE	1
6	填料 PACKING	PTFE/RPTFE	1
7	压盖 GLAND	SS304	1
8	螺母 NUT	SS304	1
9	阀杆 STEM	S304/S316	1
10	球体 BALL	S304/S316	1
11	手柄 HANDLE	S201	1
12	手柄套 HANDLE COVER	PVC	1
13	锁 LOCK	S201	1

### 主要尺寸 (MAIN SIZE) :

SIZE	1/2"	3/4"	1"	1 $\frac{1}{4}$ "	1 $\frac{1}{2}$ "	2"
DN	15	20	25	32	40	50
D	15	18	24	32	35	44
L±1.5	75	80	90	110	120	140
H	58	64	70	76	84	89.5
T	99	104	111	141	141	160
KG	0.225	0.33	0.445	0.77	0.94	1.3



# 两片式德标球阀（中体）

## 2-PC BALL VALVE -DIN3202-M3

# KX VALVE

WWW.KXCASTING.COM info@hbkaixuan.com

设计标准 (DESIGN STANDARD) : ASME B16.34 GB/T12237

螺纹标准 (THREADED ENDS) : BSP、DIN259、DIN EN ISO228、

产品型号 (PRODUCT STYLE) : Q11F-1000WOG (P/R)

公称压力 (WORKING PRESSURE) : PN63

适用温度 (TEMPERATURE RANGE) : -20°C~180°C

材 质 (MATERIAL) : ASTM-A351-CF8M、ASTM-A351-CF8

检验标准 (TEST&INSPECTION) : API598 JB/T9092

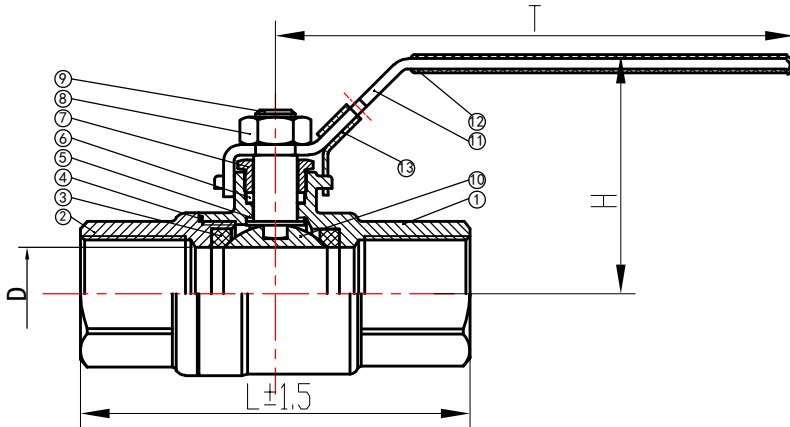

### 主要零部件材料 (MAIN PARTS MATERIALS) :

序号 NO.	零件名称 PART NAME	材质 MATERIAL	数量 QTY
1	阀体 BODY	CF8/CF8M	1
2	阀盖 CAP	CF8/CF8M	1
3	阀座 SEAT	PTFE/RPTFE	2
4	密封圈 JOINT GASKET	PTFE/RPTFE	1
5	止推垫圈 THRUST WASHER	PTFE/RPTFE	1
6	填料 PACKING	PTFE/RPTFE	1
7	压盖 GLAND	S201/S304	1
8	螺母 NUT	S201/S304	1
9	阀杆 STEM	S304/S316	1
10	球体 BALL	S304/S316	1
11	手柄 HANDLE	S201/S304	1
12	手柄套 HANDLE COVER	PVC	1
13	锁 LOCK	S201/S304	1

### 主要尺寸 (MAIN SIZE) :

SIZE	1/4"	3/8"	1/2"	3/4"	1"	1 1/4"	1 1/2"	2"	2 1/2"	3"	4"
DN	8	10	15	20	25	32	40	50	65	80	100
D	8	10	15	20	25	32	40	50	65	80	100
L±1.5	55	60	75	80	90	110	120	140	185	205	240
H	50	50	56	61	67	78	83	96	124	145	162
T	89	89	107	120	126	143	160	171	205	235	296
KG	0.205	0.205	0.28	0.4	0.6	0.845	1.31	1.765	3.995	5.71	8.505



**Anping County KaiXuan Stainless Steel Products Co., Ltd.**

**Email:** [info@hbkaixuan.com](mailto:info@hbkaixuan.com)

**Web:** [www.kxcasting.com](http://www.kxcasting.com)

**Office:** 14F-1416, No.49 Zhaiying St, Yuhua District, Shijiazhuang, 050000

**Factory:** No.17 East industrial zone, Anping county, Hebei, 053600, China